

ASSEMBLY INSTRUCTIONS

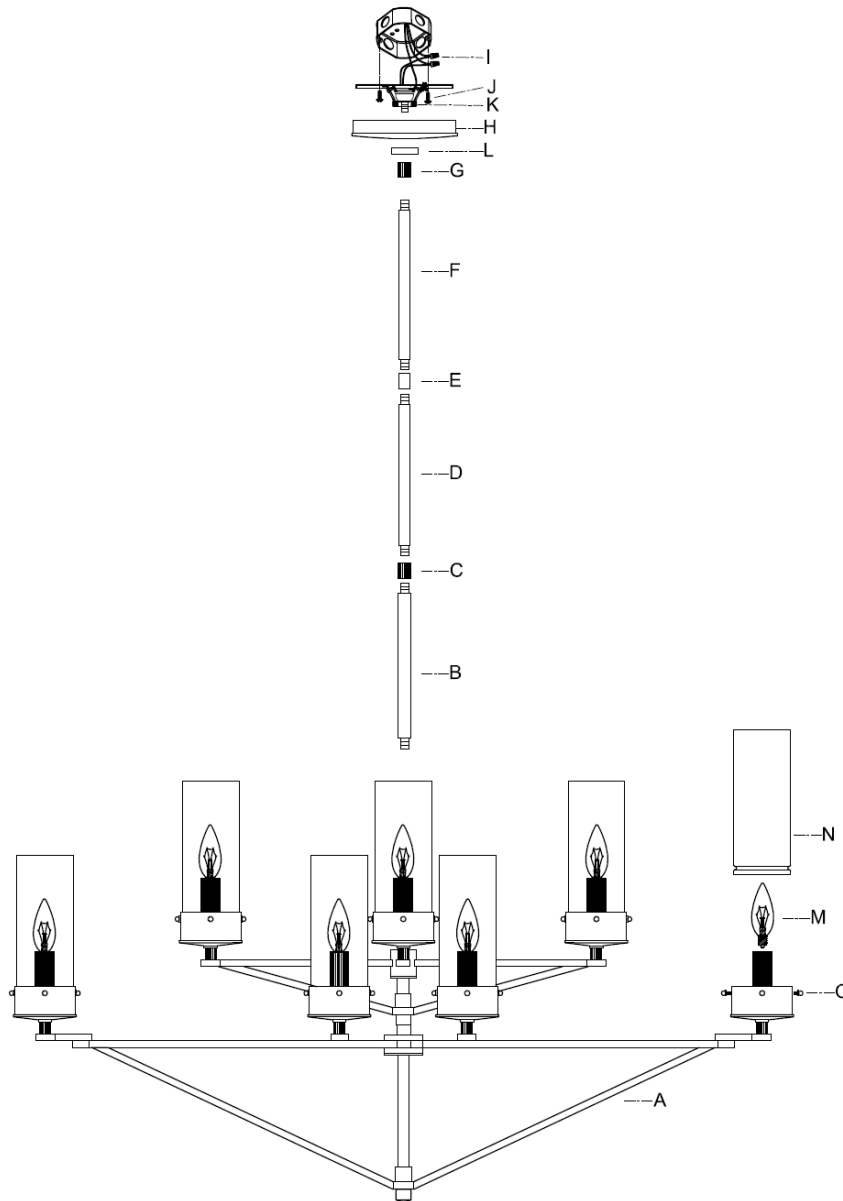

Marais Large Chandelier Item # TOB5303

WE RECOMMEND INSTALLATION OF THIS LIGHTING FIXTURE BE DONE BY A LICENSED ELECTRICIAN.

WARNING*SWITCH OFF THE MAIN ELECTRICAL SUPPLY FROM THE MAIN FUSE BOX/CIRCUIT BREAKER BEFORE INSTALLATION.**

INSPECT ITEM CAREFULLY BEFORE ATTEMPTING TO INSTALL. IF THERE IS ANY DAMAGE OR OBVIOUS DEFECT. DO NOT INSTALL.

ITEM MAY NOT BE RETURNED ONCE IT HAS BEEN INSTALLED.

NOTE: CAREFULLY UNPACK EACH PIECE IN TOP LAYER OF PACKING PRIOR TO REMOVING. RETAIN ALL PACKING MATERIAL UNTIL INSPECTION AND INSTALLATION ARE FINAL.

1. Carefully remove all parts from the box.
2. Screw off the mounting plate from the canopy (H) by lock collar (L).
3. Thread the tube (B) to the coupling (C), thread tube (D) to coupling (C), thread coupling (G) and (E) to tube (F), then thread tube (D) to coupling (E).
4. Pass cord from fixture (A) through the tubes and thread the tube(B) to the fixture (A).
5. Pass cord through the lock collar (L), canopy (H) and mounting bracket (K).
6. Install mounting plate to the outlet box by screws (J).
7. Thread the coupling (G) into bracket (K).
8. Connect the ground wire from fixture (A) to the ground wire from ceiling box.
9. Connect the hot wire from fixture (A) to the hot wire from ceiling box using wire nuts (I).
10. Repeat this procedure for the neutral wire from the fixture to the neutral wire from ceiling box using wire nuts (I).
11. **DO NOT REVERSE THE HOT AND NEUTRAL CONNECTIONS OR SAFETY WILL BE COMPROMISED.**
12. Install the canopy (H) to the mounting plate by lock collar (L).
13. Insert bulbs (M) (not included) into the sockets.
14. Insert shades (N) to the shade holders by screws (O).
15. Installation is complete, turn on power at fuse or circuit breaker.

***Clean with a dry, soft cloth only. Use no harsh abrasives or chemical agents.

